



Electrolux

Modular Preparation 1310 mm Refrigerated Cupboard with 4 Drawers

ITEM # _____

MODEL # _____

NAME # _____

SIS # _____

AIA # _____



Electrolux

1310 mm Refrigerated Cupboard with 4 Drawers
Modular Preparation

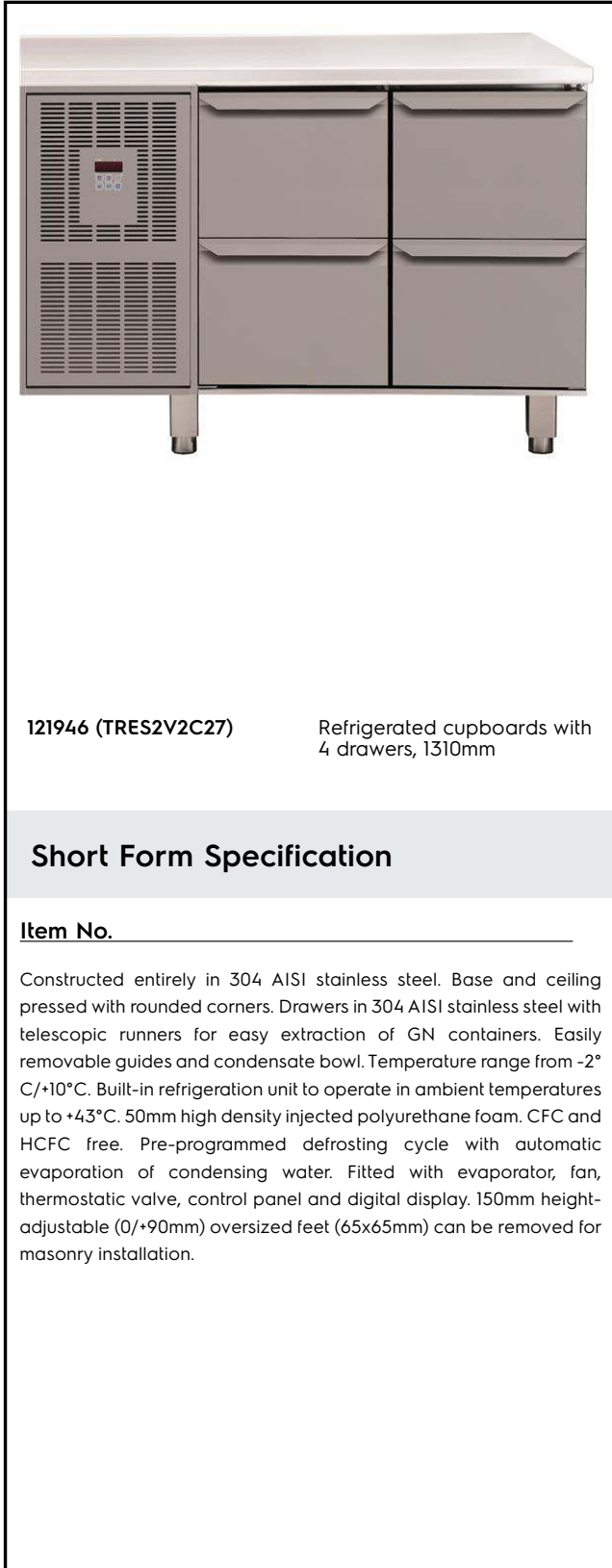

121946 (TRES2V2C27)

Refrigerated cupboards with
4 drawers, 1310mm

Short Form Specification

Item No. _____

Constructed entirely in 304 AISI stainless steel. Base and ceiling pressed with rounded corners. Drawers in 304 AISI stainless steel with telescopic runners for easy extraction of GN containers. Easily removable guides and condensate bowl. Temperature range from -2° C/+10°C. Built-in refrigeration unit to operate in ambient temperatures up to +43°C. 50mm high density injected polyurethane foam. CFC and HCFC free. Pre-programmed defrosting cycle with automatic evaporation of condensing water. Fitted with evaporator, fan, thermostatic valve, control panel and digital display. 150mm height-adjustable (0/+90mm) oversized feet (65x65mm) can be removed for masonry installation.

Main Features

- Masonry installation possible by simply removing feet.
- Extremely easy to clean thanks to the smooth edges.
- 50 mm high density injected Polyurethane foam, CFC and HCFC free.
- Long term energy savings thanks to the material's stability.
- Tropicalised refrigerated units (+43°C) even on masonry installation.
- Automatic condensing water evaporation. Pre programmed defrosting cycle.
- Adjustable temperature range from -2 °C to +10 °C to suit meat, fish and dairy storage requirements.
- Self closing stainless steel doors (< 90°).

Construction

- Mounted on 150 mm height adjustable (0/+90 mm) oversized (65x65 mm) feet.
- Telescopic runners to ease extraction of GN containers.
- Positioned on extractable guides to facilitate maintenance.
- Magnetic gaskets easy to replace.
- Base and ceiling pressed with rounded corners (R=12).
- Easy to remove guides, racks and condensate bowl.
- Constructed entirely in AISI 304 Stainless Steel with Scotch Brite finish.

Optional Accessories

- Stainless steel plinth for corner unit PNC 855823
- Stainless steel plinth for end elements, 700mm depth PNC 855837

APPROVAL: _____



Electrolux

Modular Preparation 1310 mm Refrigerated Cupboard with 4 Drawers

Front

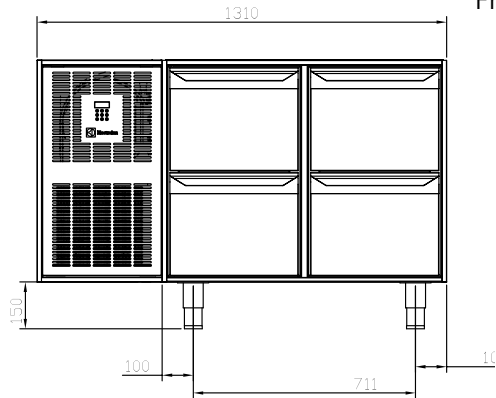

Side

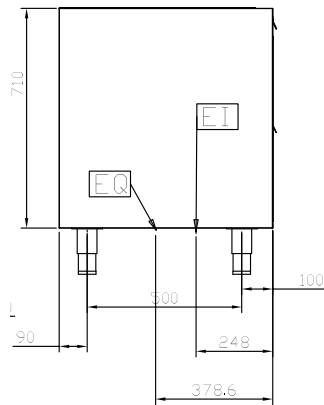

EI = Electrical inlet (power)

Top

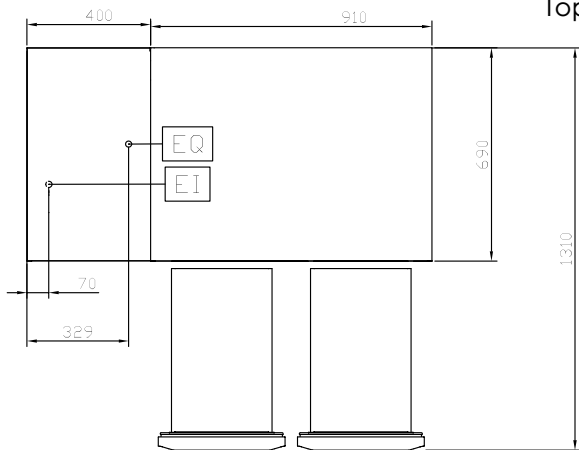

Electric

Supply voltage:

121946 (TRES2V2C27)

230 V/1 ph/50 Hz

Total Watts:

0.4 kW

Key Information:

External dimensions, Width: 1310 mm

External dimensions, Height: 860 mm

External dimensions, Depth: 690 mm

N° of drawers: 4

Modular Preparation
1310 mm Refrigerated Cupboard with 4 Drawers

The company reserves the right to make modifications to the products without prior notice. All information correct at time of printing.

2018.06.14