



Electrolux

Eco Preparation 1400 mm Wall Cupboard with 2 Sliding Doors

ITEM # _____

MODEL # _____

NAME # _____

SIS # _____

AIA # _____



Electrolux

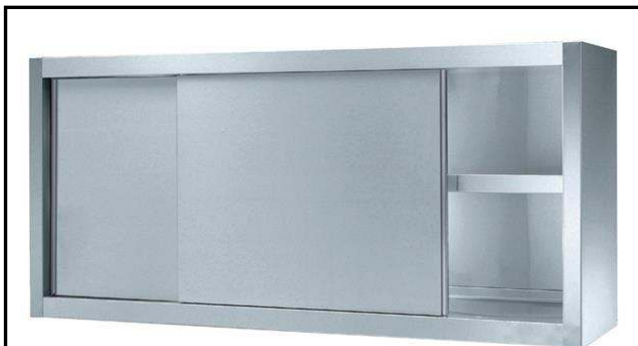

132923 (SPS14LCN)

Wall cupboard with 2 sliding doors, 1400mm

Short Form Specification

Item No. _____

Constructed in stainless steel. Inner door, intermediate shelf, rear panel and reinforcements in stainless steel. Double-walled sliding doors. Handles are formed by a fold in the sliding doors. Back and bottom are made from a single bended stainless steel

Construction

- Wall cupboard features an ergonomic handle and an internal shelf which can be positioned at three different levels.
- Two double-walled sliding doors flush fitting to the front of the frame can easily be removed without the use of tools to facilitate cleaning of the cupboard interior.
- Constructed in Stainless steel with Scotch Brite finish to meet the highest hygiene standards.

APPROVAL: _____



Electrolux

Eco Preparation 1400 mm Wall Cupboard with 2 Sliding Doors

Key Information:

N° of doors:

132923 (SPS14LCN)	2
External dimensions, Width:	1400 mm
External dimensions, Height:	650 mm
External dimensions, Depth:	400 mm

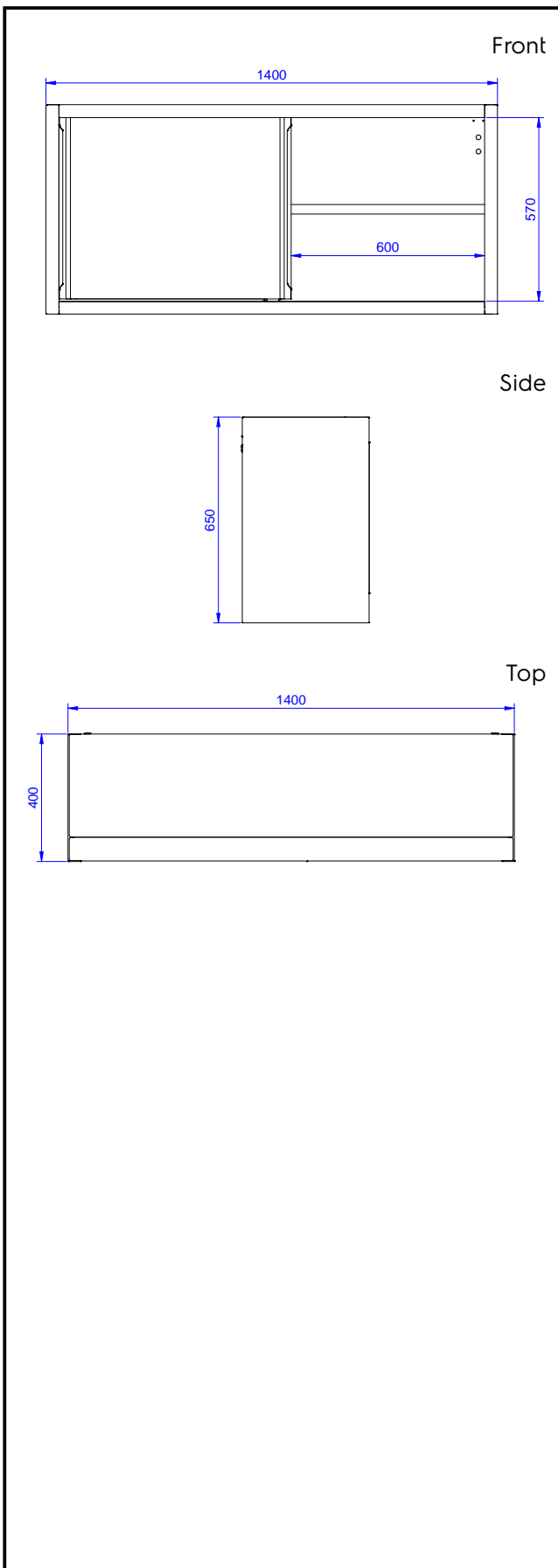

Eco Preparation
1400 mm Wall Cupboard with 2 Sliding Doors

The company reserves the right to make modifications to the products without prior notice. All information correct at time of printing.

2018.07.06