



Electrolux

Modular Cooking Range Line 900XP Full Module Electric Fry Top, Mild Steel

ITEM # _____

MODEL # _____

NAME # _____

SIS # _____

AIA # _____



Electrolux

Modular Cooking Range Line
900XP Full Module Electric Fry Top, Mild Steel



391069 - 391173 - 391070 - 391174

Short Form Specification

Item No. _____

Unit to be Electrolux 900XP Full Module Electric Fry Top. Unit to have ___smooth or ___ 2/3 smooth and 1/3 ribbed cooking surface. Electric characteristics to be ___ 400 V or ___ 230 V three phase. Cooking surface to be of mild steel. Unit to be installed on open base installations, bridging supports or cantilever systems. Unit to feature a collector on bottom the cooking surface for the collection of grease and fat. Body and work top of unit entirely in Stainless steel with Scotch Brite finish. Extra strength work top in heavy duty 2 mm Stainless steel. Unit has right-angled side edges to allow flush-fitting junction between units.

APPROVAL: _____

Main Features

- Unit to be mounted on open base cupboards, bridging supports or cantilever systems.
- Cooking surface in 15mm thick mild steel for optimum grilling results.
- Large drain hole on cooking surface permits the draining of fat into large 1 liter collector placed under the cooking surface.
- Electric elements in incoloy positioned under the cooking plate.
- Safety thermostat and thermostatic control.
- Units have separate controls for each half module of the cooking surface.
- Stainless steel high splash guards on the rear and sides of cooking surface. Splash guards can be easily removed for cleaning and are dishwasher-safe.
- The special design of the control knob system guarantees against water infiltration.
- IPX5 water protection.

Construction

- Cooking surface to be completely smooth or 2/3 smooth and 1/3 ribbed.
- Unit is 930 mm deep to give a larger working surface area.
- All exterior panels in Stainless Steel with Scotch Brite finishing.
- AISI 304 stainless steel worktop, 2mm thick.
- Model has right-angled side edges to allow flush fitting joints between units, eliminating gaps and possible dirt traps.

Included Accessories

- 1 of Stopper for fry top with PNC horizontal plate (only for 391069, 206296 391173)

Optional Accessories

- Scraper for smooth plate fry tops PNC 164255
- Junction sealing kit PNC 206086
- Support for bridge type installation, 800mm PNC 206137
- Support for bridge type installation, 1000mm PNC 206138
- Support for bridge type installation, 1200mm PNC 206139
- Support for bridge type installation, 1400mm PNC 206140
- Support for bridge type installation, 1600mm PNC 206141



- Stopper for fry top with horizontal plate (only for 391069, 391173) PNC 206296
- Chimney upstand, 800mm (only for 391069) PNC 206304
- Back handrail 800mm, Marine PNC 206308
- Back handrail 1200mm, Marine PNC 206309
- Grease/oil kit container for 700 line frytops (half and module) and 900 line frytops (module) PNC 206346
- Chimney grid net, 400mm (700XP/900) PNC 206400
- Scraper for ribbed plate fry tops - kit includes knife blades for both smooth and ribbed surface (only for 391070, 391174) PNC 206420
- Side handrail-right/left hand (900XP) PNC 216044
- Frontal handrail, 800mm PNC 216047
- Frontal handrail, 1200mm PNC 216049
- Frontal handrail, 1600mm PNC 216050
- Water drain for full module fry tops PNC 216153
- Large handrail - portioning shelf, 800mm PNC 216186
- 2 side covering panels for top appliances PNC 216278

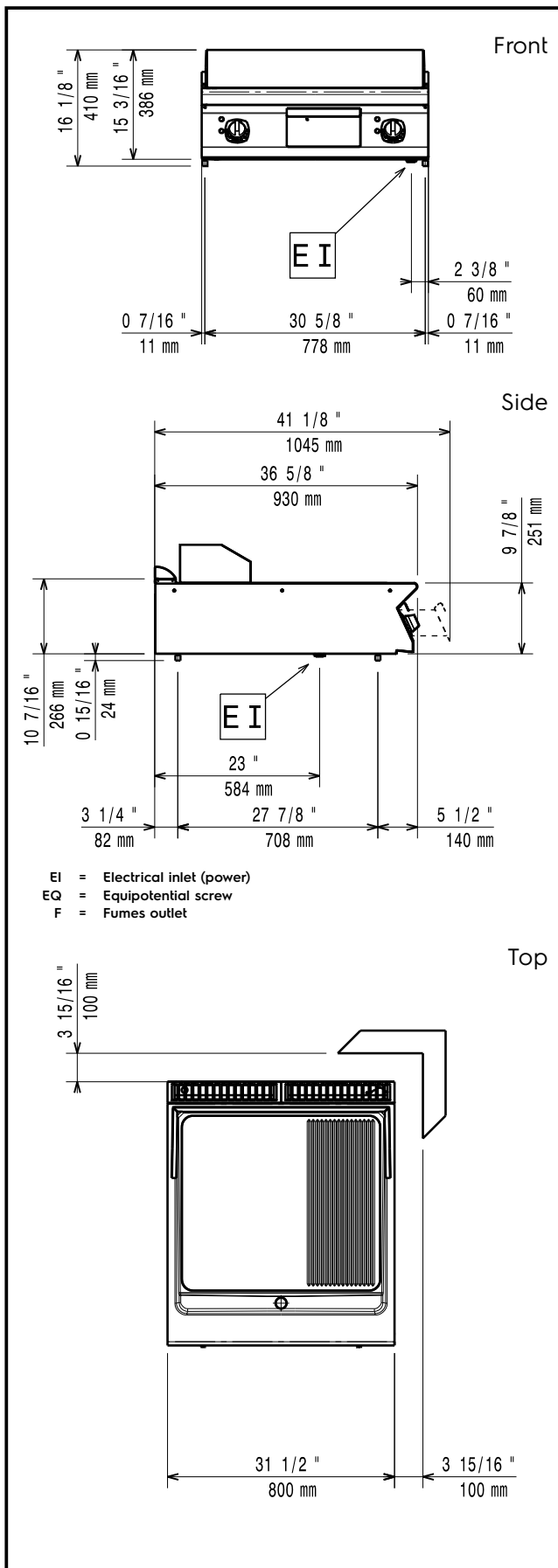

Electric

Supply voltage:

391069 (E9FTEHHS00)	380-400 V/3 ph/50/60 Hz
391173 (E9FTEHHS0N)	230 V/3 ph/50/60 Hz
391070 (E9FTEHSP00)	380-400 V/3 ph/50/60 Hz
391174 (E9FTEHSP0N)	230 V/3 ph/50/60 Hz

Total Watts:

15 kW

Predisposed for:

391069 (E9FTEHHS00)	380-400V 3- 50/60Hz 13,5-15kW
391070 (E9FTEHSP00)	380-400V 3- 50/60Hz 13,5-15kW

Key Information:

Cooking surface width: 730 mm

Cooking surface depth: 700 mm

Working Temperature MIN: 120 °C

Working Temperature MAX: 280 °C

Shipping weight:

391069 (E9FTEHHS00)	102 kg
391173 (E9FTEHHS0N)	120 kg
391070 (E9FTEHSP00)	99 kg
391174 (E9FTEHSP0N)	120 kg

Shipping height:

391069 (E9FTEHHS00)	580 mm
391173 (E9FTEHHS0N)	540 mm
391070 (E9FTEHSP00)	580 mm
391174 (E9FTEHSP0N)	540 mm

Shipping width:

391069 (E9FTEHHS00)	1010 mm
391173 (E9FTEHHS0N)	1020 mm
391070 (E9FTEHSP00)	1020 mm
391174 (E9FTEHSP0N)	1020 mm

Shipping depth:

860 mm

Shipping volume:

391069 (E9FTEHHS00)	0.5 m ³
391173 (E9FTEHHS0N)	0.5 m ³
391070 (E9FTEHSP00)	0.51 m ³
391174 (E9FTEHSP0N)	0.5 m ³

If appliance is set up or next to or against temperature sensitive furniture or similar, a safety gap of approximately 150 mm should be maintained or some form of heat insulation fitted.