



Electrolux

Modular Cooking Range Line 900XP Electric Bratt Pan 100lt with Duomat bottom

ITEM # _____
MODEL # _____
NAME # _____
SIS # _____
AIA # _____



Electrolux

Modular Cooking Range Line
900XP Electric Bratt Pan 100lt with Duomat bottom



391149 (E9BREJDPF0)

100-lt electric tilting braising
pan with Duomat cooking
surface, thermostatic control

Short Form Specification

Item No.

Infrared heating elements positioned below the cooking surface. Duomat cooking surface for roasting, browning, stewing, preparation of sauces, sautéing, boiling and braising. Can be installed on cantilever systems. Installation on wheels is not available. Includes mechanism to manually tilt the pan and double-skinned lid in stainless steel. Cooking temperature can be set through thermostat and the energy input through an energy regulator. Exterior panels of unit in stainless steel with Scotch Brite finish. Right-angled side edges to allow flush-fitting junction between units.

Main Features

- Bratt pan ideal for sautéing, poaching, steaming, boiling, stewing and damp cooking.
- Duomat cooking surface allows to perform wet and dry cooking alternatively.
- Double-skin well and lid to reduce heat dispersion.
- Infrared heating elements mounted below the cooking surface.
- Lid is double-lined, insulated in 20/10 Stainless steel.
- IPX5 water resistance certification.
- Actual cooking temperature setting through adjustable thermostat.
- Working temperature can be set from 120 °C to 300 °C.
- Energy input controlled by energy regulator.
- Heat-insulated: limited heat radiation and low energy consumption.
- Manual tilting mechanism to facilitate pan emptying.
- Smooth large surfaces, easy access for cleaning.
- The special design of the control knob system guarantees against water infiltration.

Construction

- Cooking surface with Duomat bottom: a 10 mm-thick alloy obtained from the combination of 2 different stainless steels for better thermal stability and corrosion resistance.
- All pan internal surfaces round and polished for better hygiene.
- All exterior panels in Stainless Steel with Scotch Brite finishing.
- Model has right-angled side edges to allow flush fitting joints between units, eliminating gaps and possible dirt traps.
- Usable capacity of the well 85 liters.

Optional Accessories

- | | | |
|---|------------|--------------------------|
| • Flanged feet kit | PNC 206136 | <input type="checkbox"/> |
| • Frontal kicking strip for concrete installation, 1000mm | PNC 206150 | <input type="checkbox"/> |
| • Frontal kicking strip for concrete installation, 1200mm | PNC 206151 | <input type="checkbox"/> |
| • Frontal kicking strip for concrete installation, 1600mm | PNC 206152 | <input type="checkbox"/> |

APPROVAL: _____



Electrolux

Modular Cooking Range Line 900XP Electric Bratt Pan 100lt with Duomat bottom

- Frontal kicking strip, 1000mm (not for PNC 206177
refr-freezer base) ☐
- Frontal kicking strip, 1200mm (not for PNC 206178
refr-freezer base) ☐
- Frontal kicking strip, 1600mm (not for PNC 206179
refr-freezer base) ☐
- Pair of side kicking strips (not for PNC 206180
refr-freezer base) ☐
- 2 panels for service duct for single PNC 206181
installation ☐
- 2 panels for service duct for back to PNC 206202
back installation ☐
- Kit 4 feet for concrete installation PNC 206210
(not for 900 line free standing grill) ☐
- Chimney upstand, 1000mm PNC 206305
☐
- Rear paneling - 1000mm (700/900) PNC 206375
☐
- Rear paneling - 1200mm (700/900) PNC 206376
☐
- Trolley with lifting & removable tank PNC 922403
☐

Modular Cooking Range Line
900XP Electric Bratt Pan 100lt with Duomat bottom

The company reserves the right to make modifications to the products
without prior notice. All information correct at time of printing.

2018.07.17



Electrolux

Modular Cooking Range Line 900XP Electric Bratt Pan 100lt with Duomat bottom

Front

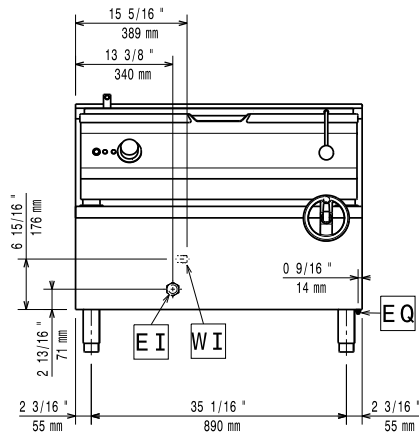

Side

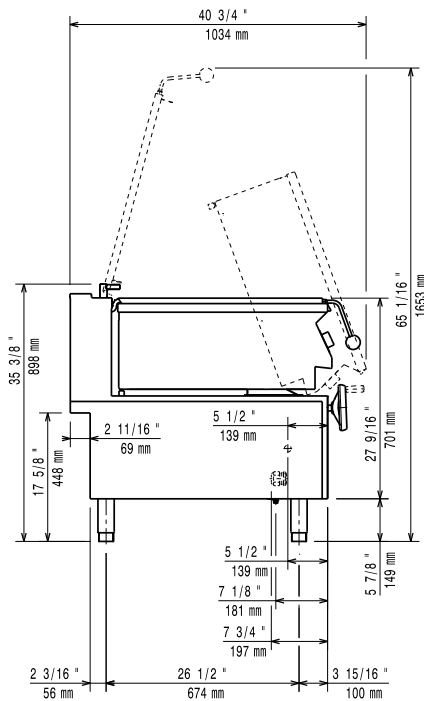

CWII = Cold Water inlet 1
EI = Electrical inlet (power)

Top

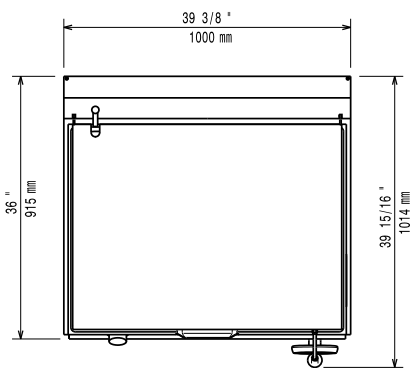

Electric

Supply voltage:

391149 (E9BREJDPF0)

380-400 V/3N ph/50/60 Hz

Total Watts:

17 kW

Predisposed for:

380-400V 3N~ 50/60Hz
15.3-17kW

Key Information:

Cooking Surface Depth: 565 mm

Cooking Surface Width: 880 mm

Cooking Well Height: 130 mm

Well Capacity, Max: 100 lt

Working Temperature MIN: 120 °C

Working Temperature MAX: 300 °C

Shipping weight: 175 kg

Shipping height: 1070 mm

Shipping width: 1020 mm

Shipping depth: 1070 mm

Shipping volume: 1.17 m³

No clearance needed on rear sides of unit if wall is of non combustible type. If wall is combustible, minimum 50 mm wall clearance should be maintained.

Modular Cooking Range Line
900XP Electric Bratt Pan 100lt with Duomat bottom

The company reserves the right to make modifications to the products without prior notice. All information correct at time of printing.

2018.07.17