

Prostore 500 1 Door Digital Refrigerator, 470lt (0/+10 °C)

ITEM # _____
MODEL # _____
NAME # _____
SIS # _____
AIA # _____



691199 (PS04RIF)

1-door prostore cabinet
470lt, 0+10°C, AISI 304

Short Form Specification

Item No.

Full door refrigerator constructed in 304 AISI stainless steel with external bottom panel in anti-corrosive material. Large digital display featuring humidity selection button (3 preset level), cabinet temperature display and setting and turbo frost cycle (to rapidly cool warm loads). HACCP-compliant control with alarms and history. Frost Watch Control to defrost only when required with automatic evaporation of defrost water. Optimized airflow provides even temperature distribution on all grids. Fitted with 65 mm-thick polyurethane insulating foam. Self-closing, on-site reversible door features microswitch to switch off the fan when the door is opened. Hidden evaporator to guarantee higher storage capacity and less corrosion problems. Built-in refrigeration unit; ventilated operation; Interior LED light. For ambient temperatures up to 43 °C. CFC and HCFC free. R134a ecological refrigerant type, cyclopentane gas in foam. Supplied with 4 x 520X442mm Rilsan coated grids and n. 4 sets of 2 stainless steel grid runners. Prearranged to fit RS485 port to facilitate connection to a remote computer and integrated HACCP systems.

Main Features

- Large digital white-digit display with humidity selection button (3 preset level), cabinet temperature display and setting and turbo frost cycle (to rapidly cool warm loads).
- IPX5 frontal water protection.
- Tropicalized unit (43°C ambient temperature).
- Fully compliant HACCP digital control: when temperature exceeds critical limits, acoustic and visual alarms are activated. Up to two months of event are kept in memory.
- Large storage area suitable to contain 520x442 mm grids or shelves to improve net capacity.
- Optimized airflow within the chamber guarantees uniformity of temperature on all grids.
- Frost Watch Control: fully automatic defrost starts only when ice is actually building-up in the evaporator and adapt the defrosting duration to guarantee perfect ice removal while optimizing energy efficiency consumption.
- Hidden evaporator thus guaranteeing higher storage capacity and less corrosion problems.
- Greater storage space: internal structure with numerous charging positions available to host grids, ensuring higher net capacity.
- Adjustable temperature range from 0°C to +10°C.
- Insulation thickness: 65 mm of polyurethane injected with ecological foaming gas cyclopentane to ensure effective insulation with minimum energy consumption (thermal conductivity: 0,020 W/m*K).
- Removable triple-chamber balloon magnetic gasket to improve insulation and reduce energy consumption and ease of cleaning.
- Cleaning-free condenser: the structure of the wire frame condenser prevents dust and grease accumulation thus avoiding periodical cleaning operations and reducing energy consumption.
- Optical door microswitch to stop the fan once the door is opened, thus minimizing energy waste.
- Model requires only 1 phase 230V/50Hz supply and can be plugged straight into an existing power socket.
- Interior LED light to save energy and for best internal visibility.
- Automatic evaporation of the defrosting water by hot gas on the top for energy saving.
- Prearranged to fit RS485 port to facilitate connection to a remote computer and integrated HACCP systems.
- Complies with main international certification

APPROVAL: _____



Electrolux

Prostore 500
1 Door Digital Refrigerator, 470lt
(0/+10 °C)

bodies and is CE marked.

- Prearranged for remote alarm.
- Low noise level.
- Self closing and on site reversible left/right doors.
- This appliance is intended for use in ambient temperatures up to 40°C.



Prostore 500
1 Door Digital Refrigerator, 470lt (0/+10 °C)

The company reserves the right to make modifications to the products without prior notice. All information correct at time of printing.

2018.07.02



Electrolux

Prostore 500 1 Door Digital Refrigerator, 470lt (0/+10 °C)

Construction

- Stainless steel AISI 304 external panels (galvanized external back).
- Inner cell with rounded corners, bottom pressed in only one piece.
- Stainless steel runners and supports easily disassembled.
- Internal components removable without the use of tools to facilitate cleaning operations.
- Pressed stainless steel door handle without joints gathering dust and dirt.
- CFC and HCFC free (ecological refrigerant type: R134a, - gas in foam: cyclopentane).
- Easy access to the main components for maintenance.
- Developed and produced in ISO 9001 and ISO 14001 certified factory.

Included Accessories

- | | |
|--|------------|
| • 4 of Plastic coated grid (520x442) | PNC 880319 |
| • 4 of Pair of runners for 470 and 720lt prostore cabinets | PNC 880335 |

Optional Accessories

- | | |
|---|-------------------------------------|
| • Kit integrated HACCP for digital refrigerators (IR33) | PNC 880252 <input type="checkbox"/> |
| • Plastic coated grid (520x442) | PNC 880319 <input type="checkbox"/> |
| • Stainless steel grid (520x442) | PNC 880321 <input type="checkbox"/> |
| • Pedal opening for cabinets | PNC 880324 <input type="checkbox"/> |
| • Kit 4 feet, height 200mm | PNC 880325 <input type="checkbox"/> |
| • Kit of 4 feet-h=67 (marine) | PNC 880326 <input type="checkbox"/> |
| • Kit pair of runners (marine) | PNC 880327 <input type="checkbox"/> |
| • Base frame for 1/1 GN rack for 470lt prostore | PNC 880328 <input type="checkbox"/> |
| • Pair of runners for 470 and 720lt prostore cabinets | PNC 880335 <input type="checkbox"/> |



Prostore 500
1 Door Digital Refrigerator, 470lt (0/+10 °C)

The company reserves the right to make modifications to the products without prior notice. All information correct at time of printing.

2018.07.02

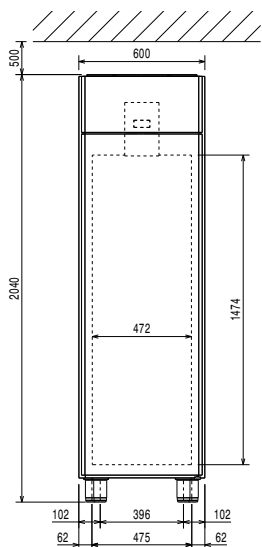
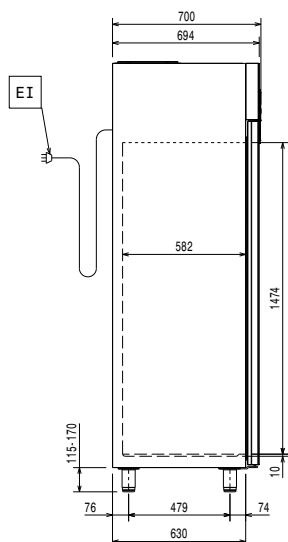
Front

Side

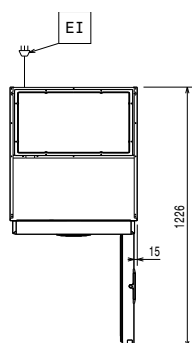
EI = Electrical inlet (power)
 RI = Refrigerant Inlet
 RO = Refrigerant Outlet

Top

Electric

Supply voltage:
 691199 (PS04R1F) 230 V/1 ph/50 Hz
 Electrical power max.: 0.205 kW

Key Information:

Gross capacity: 470 lt
 Net Volume: 316 lt
 Door hinges: Right Side
 External dimensions, Width: 600 mm
 External dimensions, Height: 2040 mm
 External dimensions, Depth: 700 mm
 External dimensions, Depth with Doors Open: 1226 mm
 Number and type of doors: 1 Full
 Internal Dimensions (depth): 582 mm
 Internal Dimensions (height): 1474 mm
 Internal Dimensions (width): 472 mm
 Noise level: 52.4 dBA
 Height adjustment: 15/40 mm
 Number and type of grids (included): 4 - 530x400
 Type of external material: 304 AISI
 Type of internal material: 304 AISI
 Number of positions & pitch: 0; 0 mm

Refrigeration Data

Control type: Digital
 Compressor power: 1/5 hp
 Refrigerant type: R134a
 Refrigeration power: 278 W
 Refrigeration power at evaporation temperature: -10 °C
 Refrigerant weight: 160 g
 Operating temperature min.: 0 °C
 Operating temperature max.: 10 °C
 Operating mode: Ventilated
 Cooling unit: Built-In
 Defrost type: By Air

Product Information (EU Regulation 2015/1094)

Energy Class: D
 Yearly and daily energy consumption: 737kWh/year - 2.02kWh/24h
 Climate class: Heavy Duty (5)
 Energy Efficiency Index (EEI): 65,35
 Type of model: vertical chilled

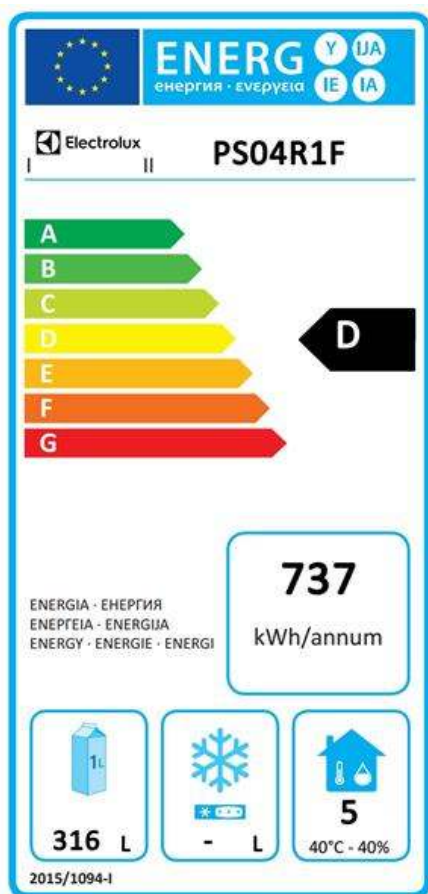

EU energy labelling from 1st July 2016

The European energy labelling scheme for professional refrigerators and freezers is based on requirements setting Minimum Energy Performance standards for commercial refrigeration cabinets sold within the EU. These requirements are designed to drive energy efficiency and environmentally friendly approach for professionals. The European energy labelling scheme will apply to all manufacturers and importers who sell and market products within the EU and it is mandatory across Europe.

Important: all products which consume energy above the minimum level will not be able to be sold within the EU from 1 July 2016.